

KCI Fleet Maintenance Facility

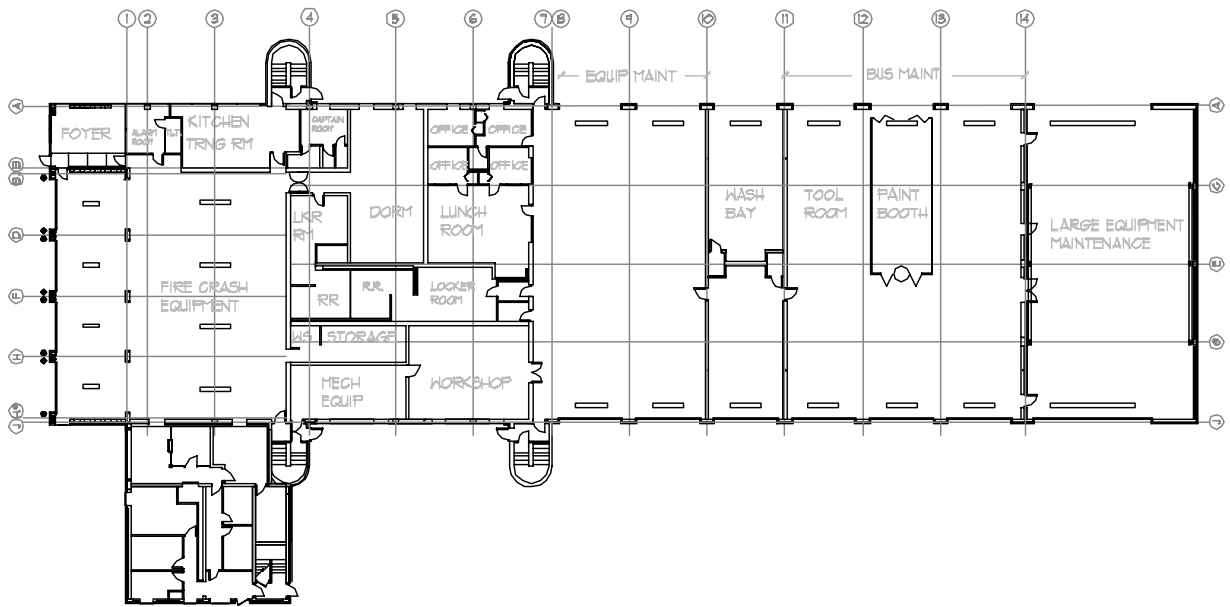

As part of a study of five buildings at Kansas City International Airport, Wellner analyzed the existing Fleet Maintenance building, determined the deficiencies of the building and recommended modifications to upgrade and expand the facility. The study determined the number of bays currently required for routine and emergency maintenance for equipment and busses. Recommendations for the facility included replacement of the HVAC system throughout the maintenance area, widening of the existing bay doors, and converting the rescue support space into facilities for women. Wellner provided design options for expansion of the maintenance bays and conversion of the equipment storage space into an equipment paint booth and body shop.

Construction Cost	\$1,393,000 (estimate)
Date Complete	2001
Key Personnel	Julie Wellner