

Hoechst Marion Roussel World Headquarters

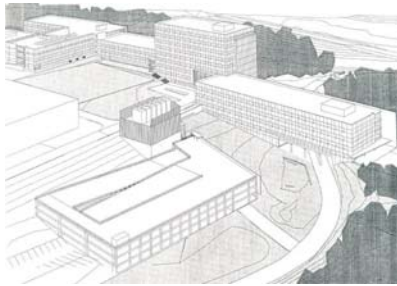

The new, 850,000 square foot headquarters buildings for Hoechst Marion Roussel included new offices for approximately 1,600 employees and related support spaces including, but not limited to, food service areas, conference rooms, training rooms, state-of-the-art video-conference rooms, a library, a copy center, a mail center and high-density document storage. Wellner Architects' responsibilities began with building programming and space planning for employee offices. Wellner ultimately focused on furniture-related services. Further descriptions of services provided are listed below:

Programming: Department meetings to determine functions, space requirements, adjacencies, equipment requirements, and capacities.

Space Planning: Preliminary department layout to determine square footage requirements and location in the building.

Furniture Services: Systems furniture design meetings, furniture installation drawings, tele/data equipment inventory and location, furniture inventory and new furniture procurement services.

Miscellaneous Interior Services: Art coordination, signage coordination, evacuation maps.

Move Coordination: Monitoring the process of eight phases of moves, determine master relocation schedule, daily guidance and assistance during the moves.

Post Occupancy Services: As-built drawings.

Construction Cost	\$100,000,000 (total including shell) \$10,000,000 (Wellner's services of programming, space planning, furniture systems and move coordination)
Date Complete	1995
Key Personnel	Julie Wellner, Marie Boatright, Secely Palmer

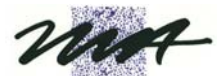

Wellner Architects, Inc.